



LOWRY CLOSE

Corby, Northants, NN18 0QT | £140,000



"Ideal investment or first time purchase within walking distance of town centre"



Lowry Close, Corby, NN18 0QT

Ideally located within easy walking distance of the town centre is this well presented modern two bedroom ground floor apartment. The property would ideally suit first time or investment purchasers and the accommodation comprises: entrance hall, storage cupboard, spacious living/dining room, fitted kitchen, two double bedrooms and a bathroom with modern suite. The property also benefits from gas central heating, double glazing and outside there is an allocated parking space. Call today to arrange an appointment to view!

Ground Floor: Approached via communal entrance hall with security intercom system. Entrance door opens to entrance hall with built-in storage cupboard and built-in airing cupboard plus doors to other rooms. The spacious living/dining room provides a comfortable place to relax and has windows to front and rear. Access leads through to the kitchen which is fitted with a range of modern units and built-in cooking appliances and has a window to front. Bedroom 1 is a good size double room with windows to side and rear. bedroom 2 is another double room with windows to side and front. The bathroom with fitted with a white 3 piece suite with a shower over the bath and a window to the rear.

Outside: To the rear is allocated Off Road Parking



2  bedrooms 1  bathrooms
1  receptions

Council Tax Authority: North Northants

Tenure: Leasehold

Energy Efficiency Rating: 76

Ground Floor

Approx. 57.5 sq. metres (618.9 sq. feet)

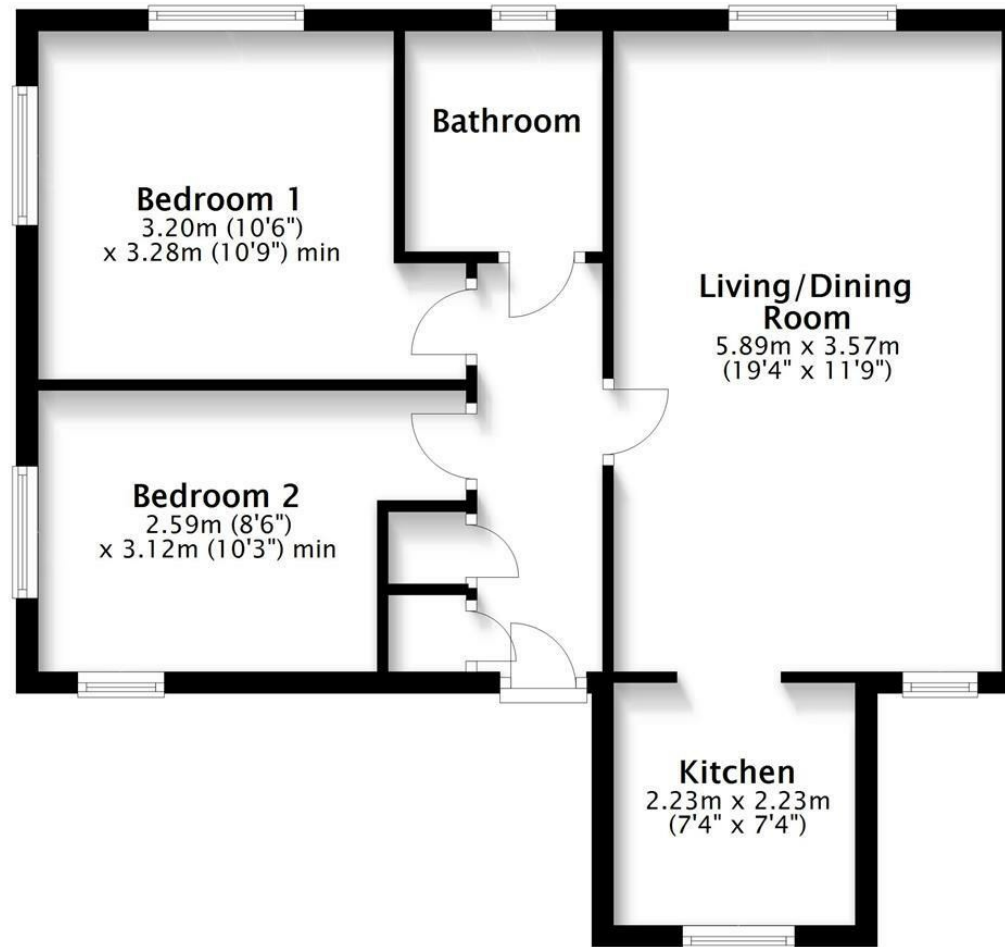

Total area: approx. 57.5 sq. metres (618.9 sq. feet)



HOWE
RESIDENTIAL

e: sales@howeresidential.co.uk t: 01536 268844 www.howeresidential.co.uk

Howe Residential & their clients give notice that: **1.** These sales and particulars do not constitute any part of an offer of contract, and are for the guidance of prospective purchasers only and should not be relied on as statements of fact. **2.** No representations are made in these particulars as to the condition of the property or as to whether any service or facilities are in good working order. **3.** All Measurements are approximate.