



# MAIDFORD ROAD

Corby, Northamptonshire, NN17 2NR | £220,000



HOWE  
RESIDENTIAL







# Maidford Road, Corby, NN17 2NR

Open plan living space! This well presented three bedroom town house is located within a quiet cu de sac on the popular Lodge Park estate. The property features a ground floor extension which provides a wonderful open plan style living space that would ideally suit a young family. The accommodation includes: entrance hall, living room, family/dining room, fitted kitchen, utility room, landing, 3 bedrooms, bathroom and separate WC. Features include double glazing and gas radiator central heating. Outside there is an enclosed front garden together with a superb larger than average enclosed rear garden which features a timber summer house/home office. Early viewing advised.

ENERGY RATING : C  
COUNCIL TAX BAND: A



3  bedrooms 1  bathrooms  
2  receptions

**Council Tax Authority:** North Northants

**Tenure:** Freehold

**Energy Efficiency Rating:** 71

## Ground Floor

Approx. 47.6 sq. metres (512.2 sq. feet)

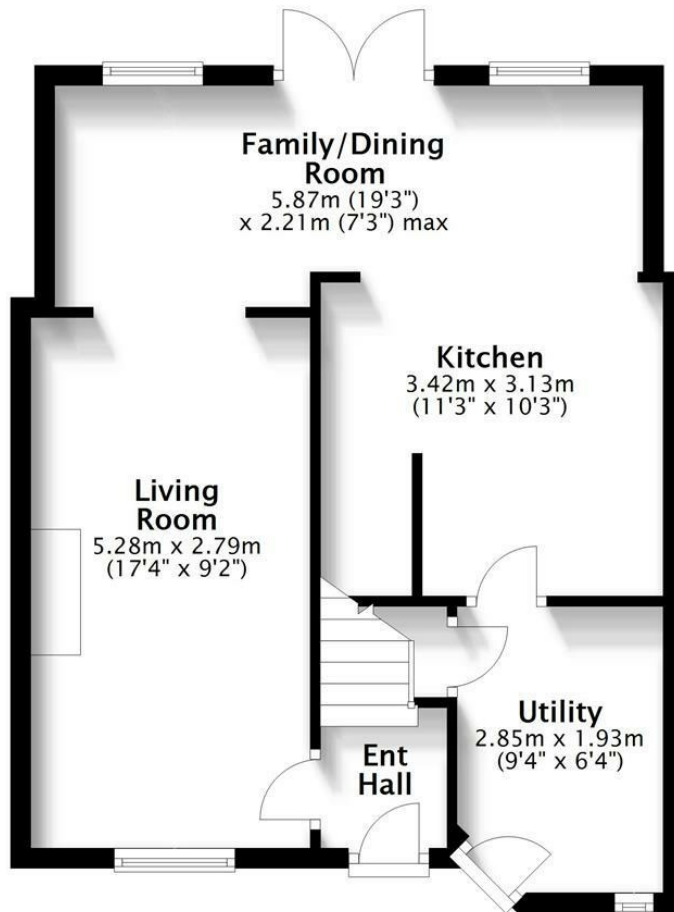

## First Floor

Approx. 33.4 sq. metres (359.5 sq. feet)

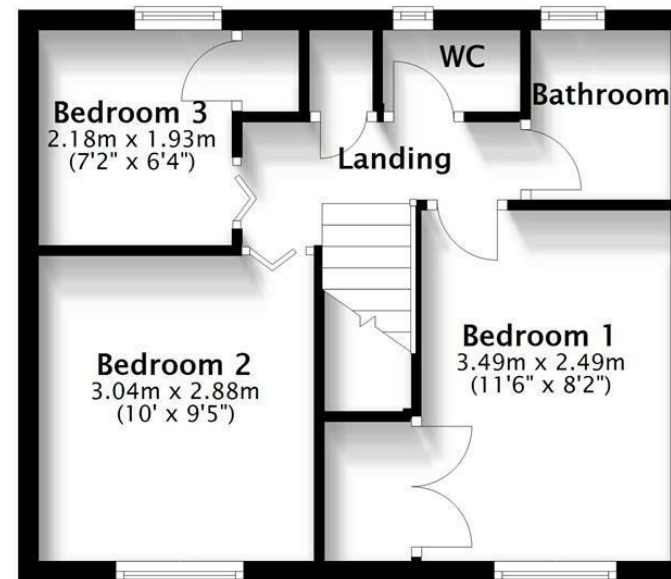

Total area: approx. 81.0 sq. metres (871.7 sq. feet)



**HOWE**  
RESIDENTIAL

e: [sales@howeresidential.co.uk](mailto:sales@howeresidential.co.uk) t: 01536 268844 [www.howeresidential.co.uk](http://www.howeresidential.co.uk)

Howe Residential & their clients give notice that: **1.** These sales and particulars do not constitute any part of an offer of contract, and are for the guidance of prospective purchasers only and should not be relied on as statements of fact. **2.** No representations are made in these particulars as to the condition of the property or as to whether any service or facilities are in good working order. **3.** All Measurements are approximate.