



# MAIN STREET

Middleton, Market Harborough, Leicestershire, LE16 8YU | £775 Per



HOWE  
RESIDENTIAL



Village life! This two bedroom end terrace cottage is situated in the heart of this popular village. The property has been refurbished by the current owner and the accommodation includes: living room with feature fire place, modern fitted kitchen, landing, two bedrooms and modern refitted bathroom. The property also features gas radiator central heating and has a courtyard garden together with brick built outhouses. Call today to arrange an appointment to view. ENERGY RATING: D NO SMOKERS/ NO PETS





## Main Street, Middleton, Market Harborough, LE16 8YU

Village life! This two bedroom end terrace cottage is situated in the heart of this popular village. The property has been refurbished by the current owner and the accommodation includes: living room with feature fire place, modern fitted kitchen, landing, two bedrooms and modern refitted bathroom. The property also features gas radiator central heating and has a courtyard garden together with brick built outhouses. Available End of June 20022. No Pets or Smokers



2  bedrooms 1  bathrooms  
1  receptions

**Council Tax Authority:**

**Tenure:**

**Energy Efficiency Rating: 65**

## Ground Floor

Approx. 23.8 sq. metres (256.1 sq. feet)

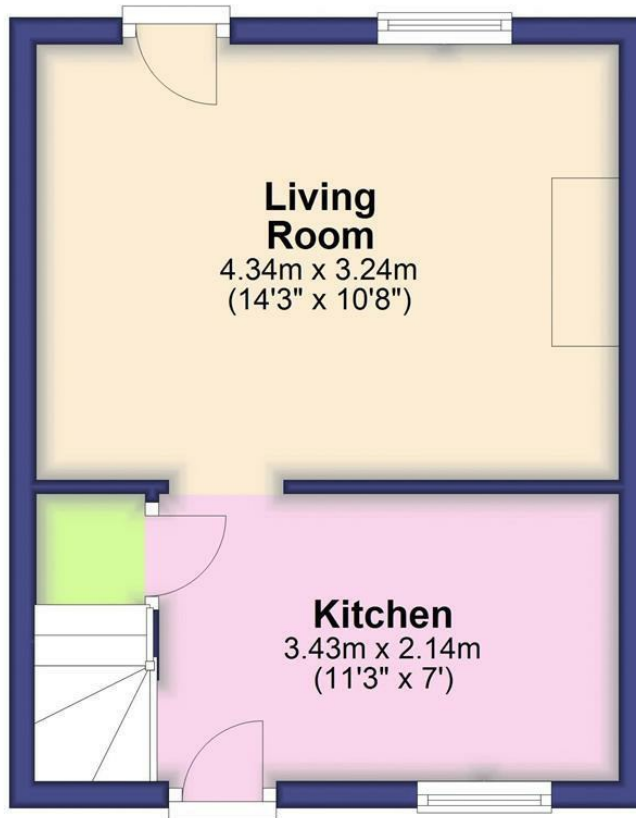

## First Floor

Approx. 25.3 sq. metres (272.9 sq. feet)



Total area: approx. 49.1 sq. metres (528.9 sq. feet)



**HOWE**  
RESIDENTIAL

e: [sales@howeresidential.co.uk](mailto:sales@howeresidential.co.uk) t: 01536 268844 [www.howeresidential.co.uk](http://www.howeresidential.co.uk)

Howe Residential & their clients give notice that: **1.** These sales and particulars do not constitute any part of an offer of contract, and are for the guidance of prospective purchasers only and should not be relied on as statements of fact. **2.** No representations are made in these particulars as to the condition of the property or as to whether any service or facilities are in good working order. **3.** All Measurements are approximate.