



WOODSIDE PARK, OUNDLE

Weldon, Corby, Northamptonshire, NN17 3JU | £97,500



HOWE
RESIDENTIAL



Woodside Park, Oundle Road, Weldon, NN17 3JU

Time To Relax! Take life easy in this immaculate park home situated on the sought after Over 55's development on the outskirts of the village of Weldon. Offered with no onward chain, features include a cosy living room, dining area, contemporary fitted kitchen and generous double bedroom. There is also a refitted contemporary shower room, double glazing throughout and gas heating. The property is situated on a plot with garden space all around and a garden shed. So put your feet up, relax and enjoy your retirement years!

ENERGY RATING: N/A COUNCIL TAX BAND: A



1  bedrooms 1  bathrooms
1  receptions

Council Tax Authority: North Northants

Tenure: Leasehold

Energy Efficiency Rating: null

Ground Floor

Approx. 459.4 sq. feet

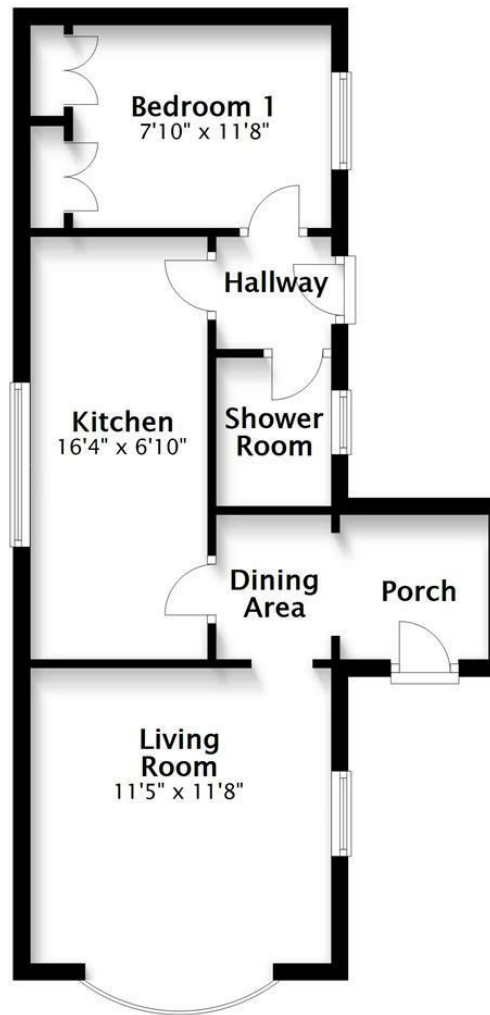

Total area: approx. 459.4 sq. feet



HOWE
RESIDENTIAL

e: sales@howeresidential.co.uk t: 01536 268844 www.howeresidential.co.uk

Howe Residential & their clients give notice that: **1.** These sales and particulars do not constitute any part of an offer of contract, and are for the guidance of prospective purchasers only and should not be relied on as statements of fact. **2.** No representations are made in these particulars as to the condition of the property or as to whether any service or facilities are in good working order. **3.** All Measurements are approximate.