

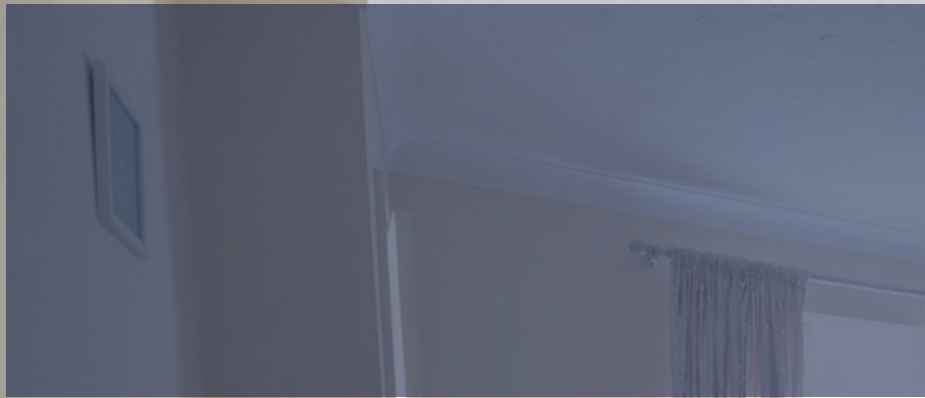

INWOOD CLOSE

Corby, Northamptonshire, NN18 8LG | £195,000





Inwood Close, Corby, NN18 8LG

Get Off To A Great Start ! This modern two bedroom end of terrace property is situated in this cul-de-sac location in the sought after Poppyfields area of Corby and would offer the ideal first home or investment property. The living accommodation includes: modern kitchen/breakfast room, living room, two bedrooms and a coloured first floor bathroom suite. Further benefits include gas radiator central heating and Off Road Parking together with enclosed rear gardens. Call for further details. ENERGY RATING: D
COUNCIL TAX BAND: B



2  bedrooms 1  bathrooms
1  receptions

Council Tax Authority: North Northants

Tenure: Freehold

Energy Efficiency Rating: 62

Ground Floor

Approx. 23.7 sq. metres (254.8 sq. feet)

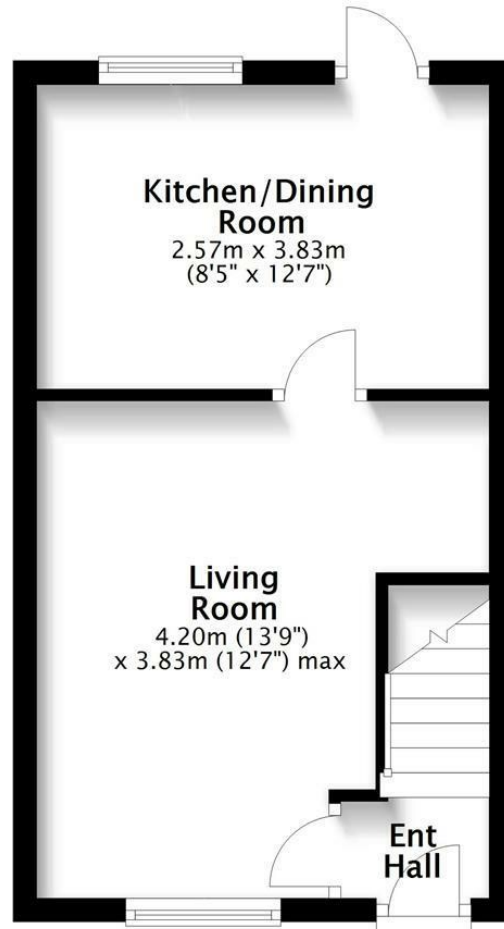

First Floor

Approx. 26.4 sq. metres (284.4 sq. feet)

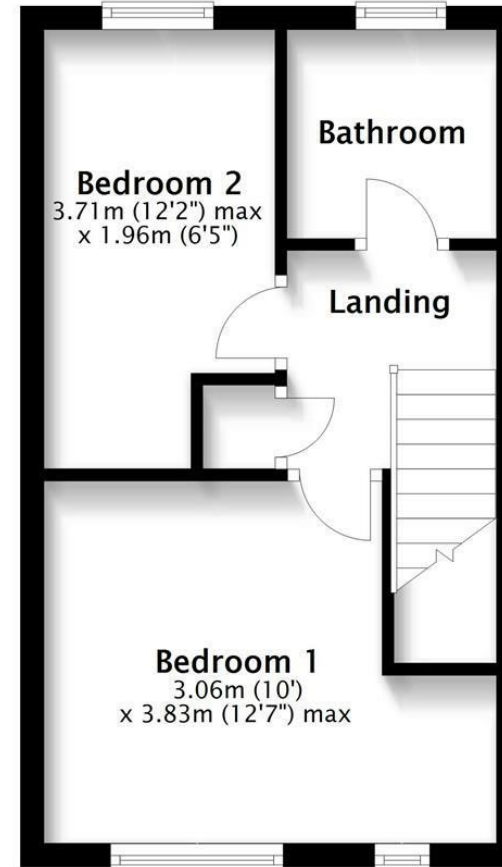

Total area: approx. 50.1 sq. metres (539.2 sq. feet)



HOWE
RESIDENTIAL

e: sales@howeresidential.co.uk t: 01536 268844 www.howeresidential.co.uk

Howe Residential & their clients give notice that: **1.** These sales and particulars do not constitute any part of an offer of contract, and are for the guidance of prospective purchasers only and should not be relied on as statements of fact. **2.** No representations are made in these particulars as to the condition of the property or as to whether any service or facilities are in good working order. **3.** All Measurements are approximate.