



MANOR COURT

Middleton, Market Harborough, Leicestershire, LE16 8TL | £295,000



' Beautifully Presented in an
Idyllic Setting '



Manor Court, Middleton, Market Harborough, LE16 8TL

Lord of the Manor! Tucked away in this after cul-de-sac in the sought after village of Middleton, is this modern link detached property which has been much improved to now offer a refitted kitchen/breakfast room with integrated appliances and a stunning open plan layout with a L-shaped living/dining/family room. Upstairs offers three bedrooms with a fabulous refitted contemporary shower room suite. Further benefits include double glazing, gas radiator central heating, well maintained gardens to front and rear and a driveway providing off road parking. A delightful property in a delightful village location.

Energy Rating: D Council Tax Band : C

The entrance hall has stairs rising to the first floor and a useful storage cupboard with doors to the living/dining room. The living room has a delightful open cast iron fireplace and window to the front. and leads to the dining/family room which has double doors leading out to the garden, a window to the rear and door to the kitchen. The contemporary fitted kitchen/breakfast room boasts built in appliances a window to the front, two feature velux rooflight windows and a door to the garden.

The first floor landing has a window to the side, loft access and doors to all first floor rooms. The master bedroom is a double room with window to the front. The second double bedroom has a window to the rear, whilst the third bedroom is a single room with window to the front. The family shower room has been superbly refitted with a contemporary suite and has a window to the rear

The property has an attractive lawned front garden enclosed by dwarf walling with a gate leading to the rear garden. The block paved DRIVEWAY provides off road parking for TWO VEHICLES. To the rear, a paved patio area leads to a well maintained lawned garden which is enclosed by fencing. there is also a further useful storage area to the rear.



3  bedrooms 1  bathrooms
1  receptions

Council Tax Authority: North Northants

Tenure: Freehold

Energy Efficiency Rating: 72

Ground Floor

Approx. 47.3 sq. metres (509.5 sq. feet)

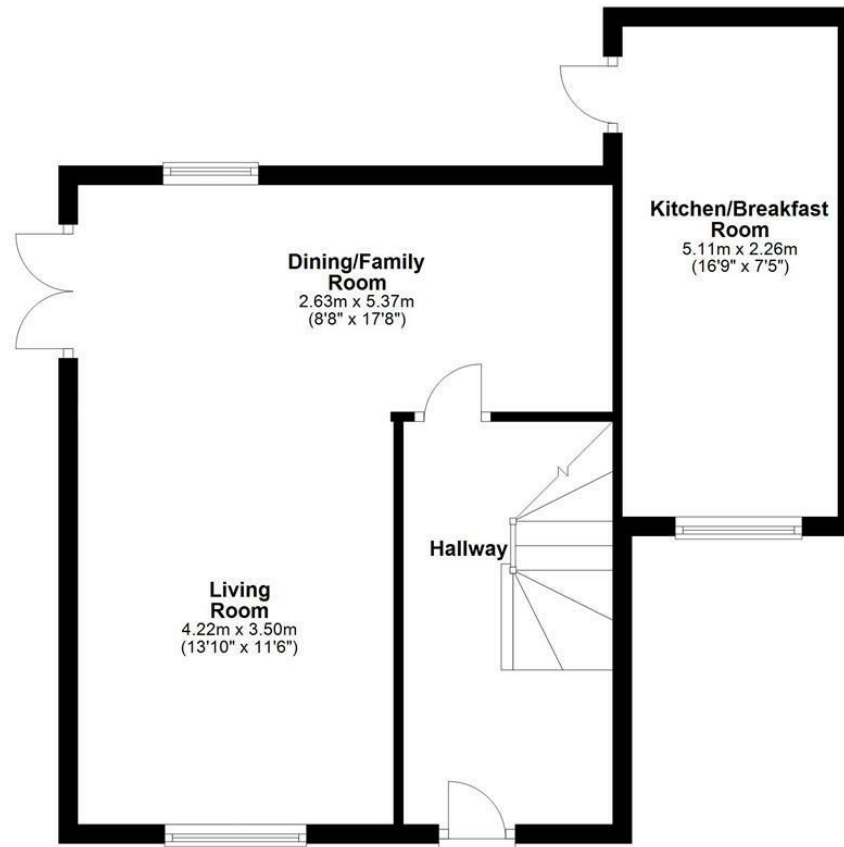

First Floor

Approx. 37.4 sq. metres (402.5 sq. feet)

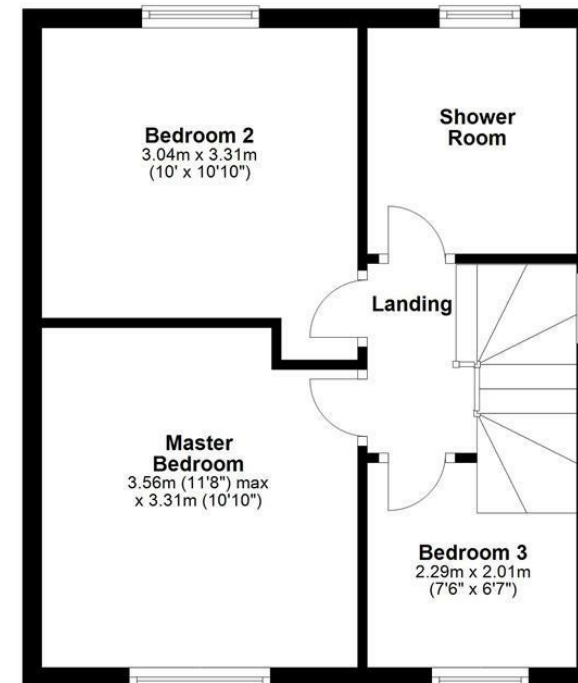

Total area: approx. 84.7 sq. metres (912.1 sq. feet)



HOWE
RESIDENTIAL

e: sales@howeresidential.co.uk t: 01536 268844 www.howeresidential.co.uk

Howe Residential & their clients give notice that: **1.** These sales and particulars do not constitute any part of an offer of contract, and are for the guidance of prospective purchasers only and should not be relied on as statements of fact. **2.** No representations are made in these particulars as to the condition of the property or as to whether any service or facilities are in good working order. **3.** All Measurements are approximate.